

D2L

Embed a Video or Audio File

You can embed Video or Audio files that you have hosted outside of D2L such as YouTube.

Embed Video or Audio:

1. After logging into D2L, click **Content**.
2. Choose the Module in which you would like to embed your video or audio file.

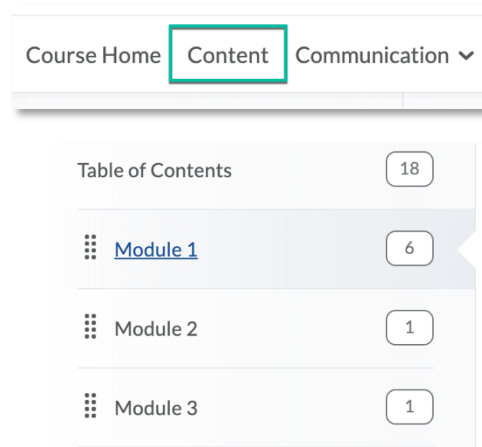

3. Click the blue **New** button and choose **Video or Audio**.

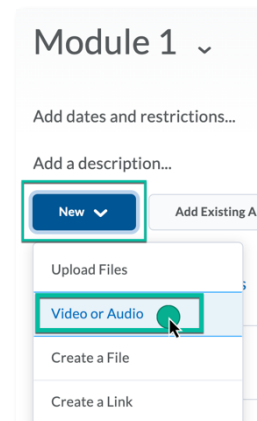

4. Under the **Web Video or Audio** tab, paste the link to your video file.

(Do not choose Upload.)

5. Edit the title for your video.
6. Click **Save**.

